



भारतीय समुद्री विश्वविद्यालय Indian Maritime University

(केन्द्रीय विश्वविद्यालय, भारत सरकार / A Central University, Govt. of India)
कोलकाता परिसर / Kolkata Campus

No. IMU-KC/Furniture/17-18

Date: 27.06.2017

Sub: Quotation for Procurement of Furniture for Seminar Hall and
Centre of Excellence at IMU-KC

Sealed quotations are invited for supply of the following furniture items for the Seminar Hall (1st Floor) and Center of Excellence (Ground Floor) of New Administrative Building at IMU-Kolkata Campus. Specifications of the required items are given below:

Sl. No.	Items	Quantity
1.	Wooden table (Seminar Hall) Specification: a) Table size: 5' - 0" L x 2' - 0" B x 2' - 6" H b) Table made of 1 st class Kapur Wood, leg 2" x 2", upper rail 3" x 1", lower rail and foot rest 2" x 1" with French polish complete. c) Top 18 mm thick Green plywood/Century plywood with 1mm thick Walnut/Rosewood colour decorative laminated finish with wooden bidding.	20 nos.
2.	Armed Cushion Chair (Seminar Hall) Specification: a) Frame made of Iron Badam Pipe with powder coating finish; Black colour. b) Seat 2" thick foam and back 1" thick and PU Handle with Maroon colour best quality tapestry cover.	40 nos.
3.	Executive Table (Seminar Hall) Specification: a) Table size: 6' - 0" L x 3' - 0" B x 2' - 6" H with right side detachable cabinet. b) Separate cabinet with three drawer on right hand side, detachable system and locking arrangement, backside of table full cover c) All made of 18 mm thick Green ply/Century Plywood with 1mm thick Walnut/Rosewood colour decorative laminated finish.	01 no.
4.	Executive Chair (Seminar Hall & Center of Excellence) Specification: a) Revolving and tilting chairs with arms. b) Seat and back foam cushion with best quality Rexine cover. c) Back low height, decorative handle. d) With 05 numbers caster wheel.	07 nos.

Amulya

पि-19, तारातला रोड, कोलकाता - 700 088 / P-19, Taratala Road, Kolkata - 700 088

Email : director.kol@imu.co.in

Phone : (033) 2401 4673/74/76/78/1946, Fax : (033) 2401 4333, Hostel : 2401 4675

5.	Green Glass Board (Seminar Hall & Center of Excellence) Specification: a) Green Glass Board with wooden frame size: 8' – 6" L x 4' – 6" H b) Wooden Frame size 3" x 1.5" made of kapur wood with 6 mm Plywood on back side of glass with french polish on frame c) 6 mm thick one side frosted glass and back side green enamel paint finish. d) Above Board to be fitted on wall.	02 nos.
6.	Wooden Podium (Seminar Hall & Center of Excellence) Specification: a) Size: 2' - 6" L x 2' - 0" B x 3' – 9"/4' – 3" H with one shelf. b) Made of 18 mm thick Green ply/Century Ply 1 mm laminate finish all in side and out side c) 1 no. tube light 2' L with electrical fittings to be fitted d) Provision of Micro Phone to be provided.	02 nos.
7.	U-Shape Table (Center of Excellence) Specification: a) U-Shape Table Size: 32' – 0" L x 2' – 6" B x 2' -6" H on both side (8' long each) with one shelf and partitions. b) Above table made in 8 pcs., back side fully covered. c) Table made of 18 mm thick Green ply / century plywood with 1 mm thick laminate finish all side (inside and outside), Walnut/Rosewood colour. d) As per drawing	01 no.
8.	Executive Table (Center of Excellence) Specification: a) Table size: 8' - 0" L x 2' – 6" B x 2' – 6" H b) Three sides cover c) All made of 18 mm thick Green ply/Century Plywood with 1mm thick decorative laminated finish.	01 no.

Terms & Conditions:

- (i) Items to be supplied should be of industry standard. Based on the specification mentioned in the quotations submitted, if IMU-KC finds that the offered product(s) are non-standard or do not meet the industry standard, the quotation will be rejected and will not be considered for evaluation. The evaluation will be based on lowest price among the quotes, which fulfill the requisite industrial standard specifications.
- (ii) If there is a need for any deviation in the specifications given in the letter inviting quotation, acceptability (if felt by IMU-KC as superior) or otherwise (in case of inferior specifications) such deviations are to be checked with IMU-KC before submission of quotations so that rejection of the quotations based on the ground of non-conformity to specifications could be avoided.
- (iii) Make, Model etc., if any, for the items should be specified in the quotations.

Amulya

- (iv) The rates quoted should be inclusive of delivery and fitting charges (if any) but excluding Taxes which should be clearly mentioned separately.
- (v) Items should be delivered preferably within 3 (three) weeks of placing order.
- (vi) Delivery and fitting of the above items should be done at IMU -Kolkata Campus at P-19, Taratala Road, Kolkata 700 088.
- (vii) Warranty Period for the items should be clearly mentioned.
- (viii) If any of the above items/part of the items are found to be defective, the same must be replaced by the supplier at their cost. No extra charges will be paid.
- (ix) Submission of multiple bids by a single firm will lead to rejection of the bids and IMU-KC may black list such firms from future participation.
- (x) Quotations for the above items in sealed envelopes superscribing "Quotation for Furniture for Seminar Hall and Center of Excellence" and addressed to the Director should reach this office positively by 10.07.2017.
- (xi) Payment will be made through Bank Transfer after successful delivery and fitting of the items.

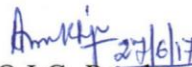
O.I.C.-Purchase

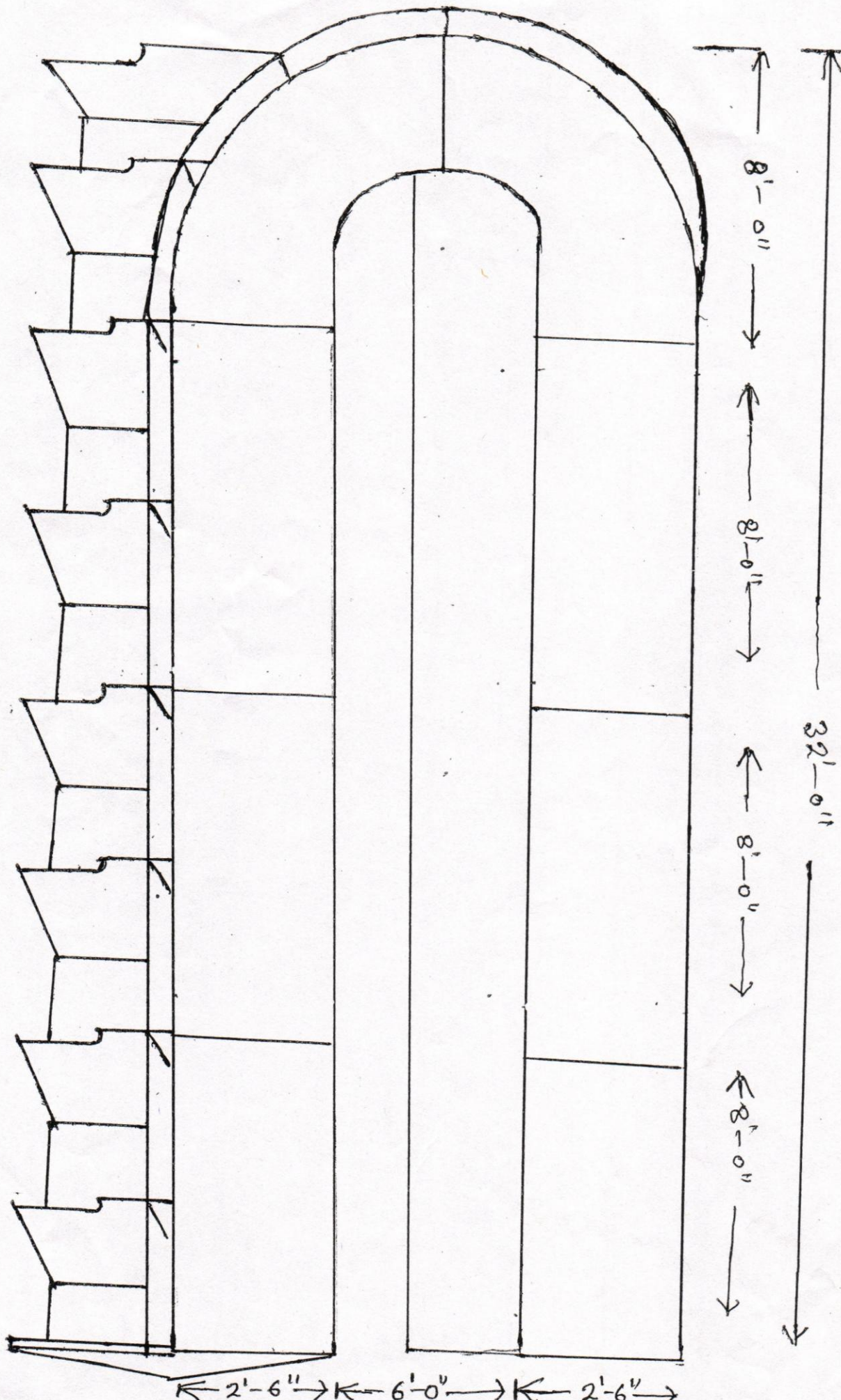

← 2'-6" → ← 6'-0" → ← 2'-6" →

U-Shaped Table